



# Moss Motors Car Cutout Model

**JAGUAR XK120**  
With a 3.4 liter DOHC engine and graceful styling the XK120 Jaguar was the star of the 1948 Earls Court Motor Show. 7,631 Roadsters built from 1949 to 1954.

It is easier to color your XK120 before you cut it out. Felt tip markers or color pencils work great.

Carefully cut out the car with an X-Acto knife or scissors.

**Tip: Cut tab slots before folding body.**

Cut out steering wheel (inside too) and glue in place.

Fold windshield to "V" shape then locate in slots on hood.

Fold down tabs, then fold over front and rear body panels, gluing or taping tabs inside to hold body curvature.

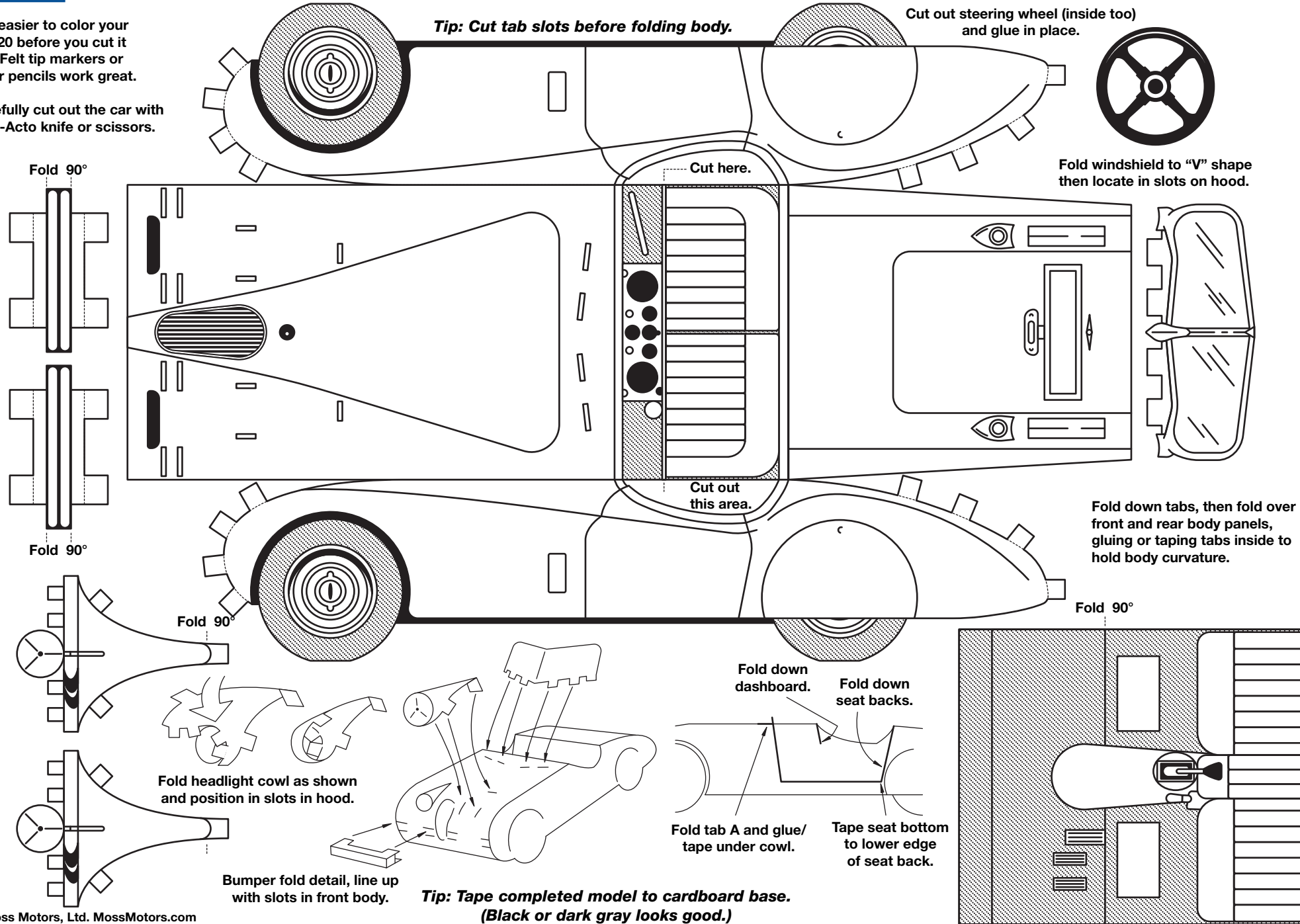

**Tip: Tape completed model to cardboard base.  
(Black or dark gray looks good.)**